

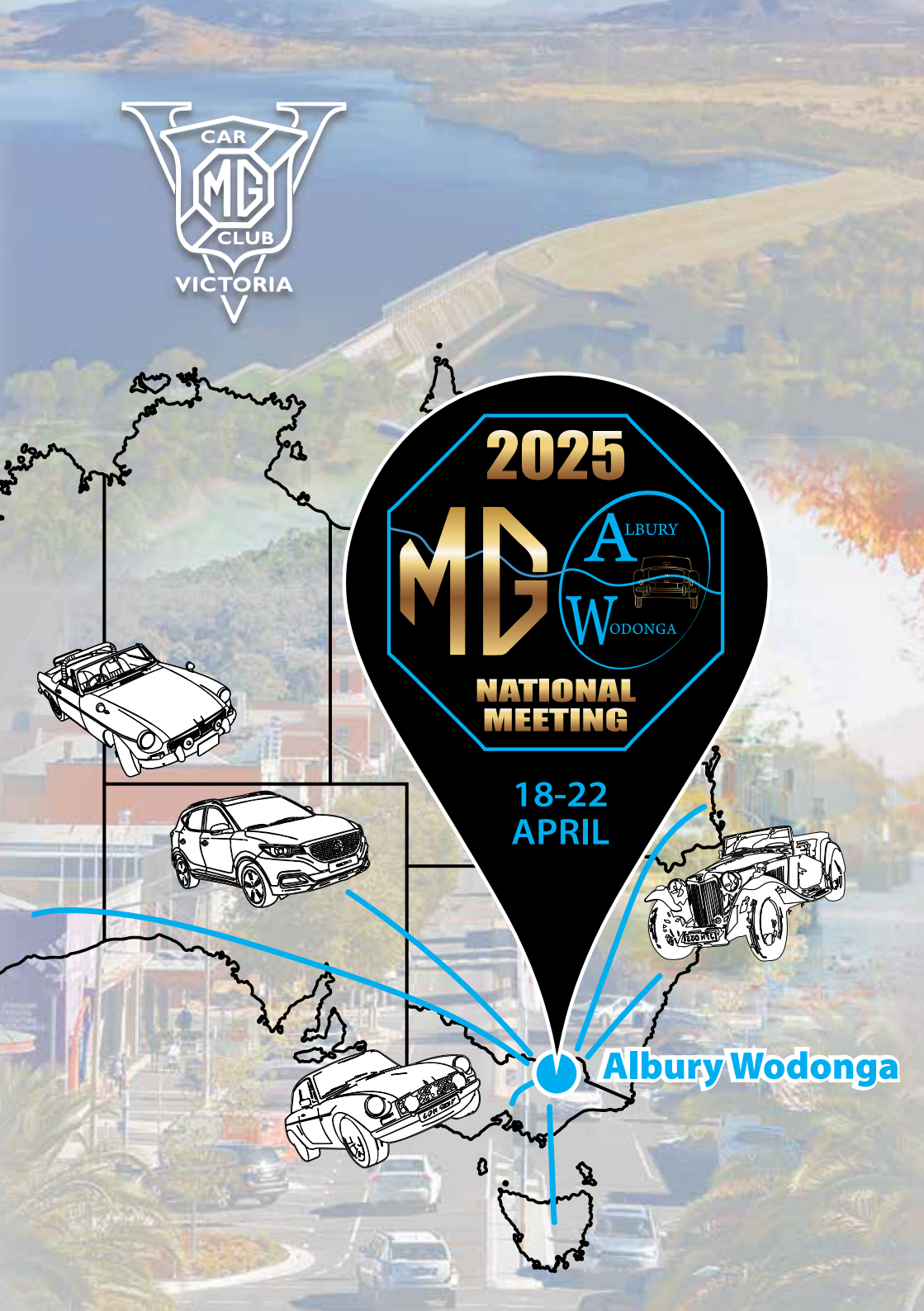

Albury Wodonga

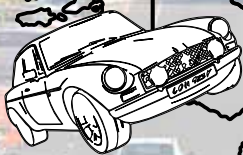

Rethink Hybrid. We did.

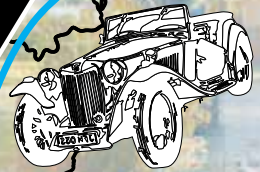
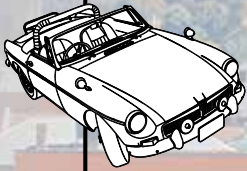

Just as the two extremes of pink and blue meet in South Australia's Lake Macdonnell, efficiency meets power with MG HYBRID+.

Defying the conventions of Hybrid technology, our engineers have pushed boundaries to bring you efficiency that lasts longer and power when you need it.

Test drive one today and experience the difference for yourself.



MG HYBRID+ model coming soon



This is your official program for the Annual MG National Meeting 2025, hosted by the MG Car Club of Victoria.

The booklet contains all the information essential for your enjoyment of the National Meeting including start times, places and directional maps.

We thank our sponsors for their support and encourage you to consider their products and services.



CONTENTS

National Meeting Events Contacts.....	4
Event Timetable.....	5
Director's Welcome.....	6
MGCC Victoria President.....	7
Peter Cook – MGCC UK Overseas Director....	8-9
MG TC – 80 years.....	10-11
Registration, Scrutineering.....	13
Rocker Cover Racing.....	14
Concours – Gateway Lakes.....	16-17
Theme Night and Concours Presentations – Commercial Club.....	18
Motorkhana – Winton Raceway.....	20-22
Kimber Run – Hume Weir.....	23
Sprint – Logic Centre.....	24-26
Discovery Run and Social Scenic Tour – Gateway Lakes.....	27
Presentation Dinner – SS&A Club.....	28
Farewell Breakfast – SS&A Club.....	28
Rules and Regulations.....	30
Awards and Trophies.....	31-33
Previous Winners.....	34-35
Competitors.....	36-42
Kimber & Discovery Runs Social Entrants...	44-45
Social Entrants.....	45
National Meeting 2026.....	46
Thank you.....	48

Photo Credits

We would like to acknowledge the following people who have taken the photos presented throughout the program:

Jan Rattray, Matthew Magilton, Steve Begley, Jane Vollebregt, Kaye Trathen (Affinity Photography), Rob Hastie, Russell Seymour, Graeme Adams and Andrew Gall.

NATIONAL MEETING EVENTS CONTACTS

Contact	Function	Mobile
Tony Lupton	Director	0409 525 159
Louise Crowther	Deputy Director	0401 267 015
Louise McKenzie	Secretary	0417 415 362
Jan Rattray	Registrar	0408 555 195
Greg Mouritz	Scrutineering	0450 848 289
Mike Herlihy	Competition Director	0419 361 725
Matthew Magilton	Rocker Cover Race	0403 989 852
Max Irvine	Concours Director	0447 504 037
John Hastie	Motorkhana Director	0400 801 320
Reg and Mary Bowran	Kimber Run	0412 189 852
Torquil Kelso	Speed Event Director	0417 398 606
Wayne and June Rushton	Discovery Run	0412 339 934

EVENT TIMETABLE

Event	Time	Venue
Friday 18th		
Registration	10:00am-3:00pm	The Cube
Scrutineering	10:00am-3:00pm	The Cube
Noggin 'n Natter	6:30pm – 10:00pm	The Cube
Rocker Cover Racing	Scrutineering: 6:30pm Commences: 7:00pm	The Cube
Saturday 19th		
Concours	8:30am – 4:00pm	Gateway Lakes, Lincoln Causeway
Theme Night Concours Presentation	6:30pm – 10:30pm	Commercial Club, Albury
Sunday 20th		
Motorkhana	8:00am – 4:00pm	Winton Motor Raceway
Kimber Run	10:00am	Commence Hume Weir
Monday 21st		
Sprint	7:00am – 4:00pm	Logic Centre, Barnawatha
Discovery Run	8:15am - 2:30pm	Gateway Lakes
Scenic Social Tour	9:30am	Gateway Lakes
Presentation Dinner	7:00pm – 11:00pm	SS&A Club Albury
Tuesday 22nd		
Farewell Breakfast	7:00am – 10:00am	SS&A Club Albury
Delegate's Meeting	From 10:00am	SS&A Club Albury



VINTAGE WIRING HARNESS
phone (03) 9870 0583
vinwire2@gmail.com
contact@vinwire.com.au

original style wiring looms
all makes and models - 1920's onwards

braided wire or pvc,
with cotton over-braiding
or original harness tape

custom modification to your
own specifications
including indicator wiring

braided HT
and battery leads

vintage wiring harness
po box 141 Smythesdale Victoria 3351 | www.vinwire.com.au
address 338 Browns Rd, Scarsdale Victoria 3351



LIGHTWAVEZ DESIGN
SOLUTION PROVIDERS

3/21 Stud Road Bayswater 3153
03 9720 1177
www.lightwavezdesign.com.au
info@lightwavezdesign.com.au

Lightwavez Corporate

- Uniforms & Corporate wear
- Promotional goods
- Caps
- Workwear
- Polos

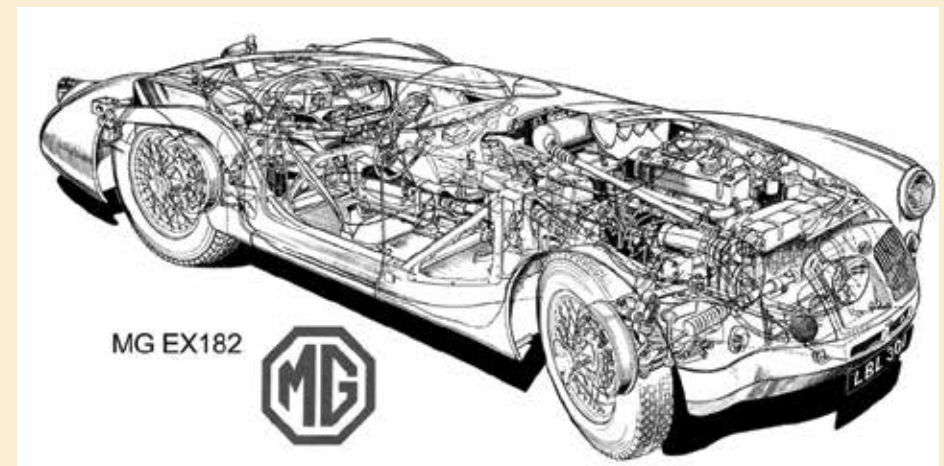

DIRECTOR'S WELCOME

Tony Lupton



Welcome to the 2025 MG National Meeting. We have a great program lined up over this Easter weekend to bring people together, to enjoy our cars and appreciate the wonderful countryside of the Border Region. Thank you for attending the meeting, as without you we wouldn't have an event.

I'm delighted that we reached our registration limit of 320 participants in early February, so it's clear the MG fraternity is very keen on our annual national get-together.

National Meetings follow a well known program, from the Noggin 'n' Natter and Rocker Cover Racing to the Concours, Sprints, Motorkhana, Discovery and Kimber Runs. All of these will be held at first class venues, including Gateway Lakes Park, Winton Raceway and the Logic Centre Driver Training complex.

Timing equipment for our Sprint events was generously provided by the Albury Wodonga and District Car Club and we thank them very much for their support.

Our thanks also go to the staff at Wodonga and Albury Councils who have been very helpful in facilitating the organisation of our events. Wodonga Council is responsible for The Cube, venue for Registration and our Friday evening activities, along with Gateway Lakes Park for the Concours. Albury Council was very helpful in assisting with accommodation options and social venues.

Our major evening functions at the Commercial Club and SS&A Club in Albury will be highlights and thanks also go to their management for providing a very helpful process.

Apart from the venues for our social and competitive events, Albury and Wodonga have many highlights to enjoy while you're here. There are drives you can take beyond the weekend's formal program, recreational

activities at Lake Hume and the Murray River, museums, galleries and wineries too numerous to mention.

I also want to take this opportunity to thank my organising committee for the time and expertise they gave to bringing the program together. In particular, Deputy Director Louise Crowther, Secretary Louise McKenzie and Registrar Jan Rattray were outstanding.

Thanks also to the organisers of the 2024 meeting in Tamworth who provided an excellent handover.

I hope you enjoy everything our National Meeting has to offer and then it's on to Adelaide for the 2026 event.

Here's to our friendly interstate competition!

Tony Lupton

Director
2025 MG National Meeting



MGCC VICTORIA PRESIDENT



Paul Vermont

Dear fellow MG Car Club Member,

It is my great pleasure to welcome you to Albury Wodonga for our 2025 MG Car Club National Meeting! This gathering represents a unique opportunity for MG Enthusiasts from all corners of the country to come together, share their passion, and celebrate the rich history and vibrant future of MG.

Over the next few days, we have an exciting lineup of activities planned, including the best display of MGs you will find anywhere in Australia. Whether it's the thrill of competition or the enjoyment of social activities, there is something for everyone. I would especially like to welcome those of you who are experiencing the National Meeting for the first time. I am sure there will be many more to follow.

This meeting is not just about cars; it is about the people who love them. We encourage you to take this opportunity to engage with other members, exchange ideas, and celebrate our

shared passion. Many of you will be catching up with the friends you have made at previous meetings which is always a highlight. The camaraderie and spirit of our collective car clubs are what make this event truly special.

We extend our heartfelt thanks to all the volunteers, sponsors, and participants who are making this event possible. Your dedication and enthusiasm are the driving force behind the success of our National Meeting.

We hope you have an unforgettable experience filled with inspiration, fun and perhaps you may even take home a gong!

Safety Fast!

Sincerely,

Paul Vermont

President
MG Car Club Victoria

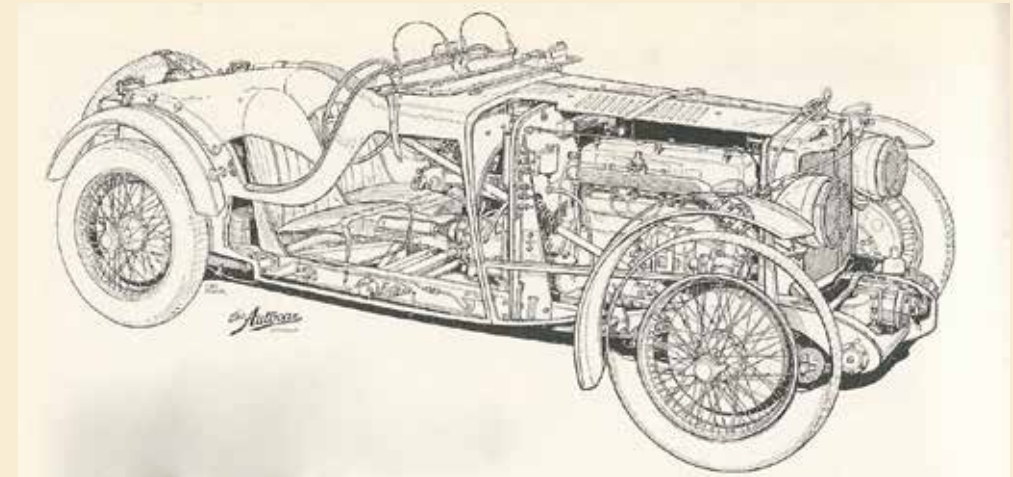

PETER COOK – MGCC UK OVERSEAS DIRECTOR



that whatever the model or the factory in which it was made (more accurately, assembled) we are all part of the same community.

Apart from the above the real enjoyment is not just the cars but the opportunity to get away from model groups or registers and mix with folks from other models and locations. There's a good chance that a sizeable minority are not that interested in the cars and want to catchup with folks from last year's National meeting and meet new participants as well.

I will be standing down as Overseas Director this coming October and hopefully somebody else will replace me and enjoy the job as much as I have done.

It will be ten years and I feel it's time for somebody else to have the opportunity to attend the great events across the globe. I have been made to feel very welcome by everybody I have met at the National meetings and have been hosted during my stays by very friendly Australian club members.

One regret I have is my inability to bring my factory MGB GTV8 to your events. I have taken it to European events in Denmark and Monaco but neither Emirates nor Qantas has been helpful in this respect!

I bought my MGB GTV8 from the Citron factory in 1981 and in the early years it was used as a normal second car for work and leisure. It had been used as a company car by the two owners of a repair garage where I took my MGB roadster for repairs. One day I turned up and they were having a row and instead of discreetly walking away I stayed for long enough to hear one of them to say – "And what's going to happen to the V8?" I said – "I'll buy it" and the deal was done.

On 27th December 1985 my wife Linda, expecting twins, nudged me awake and said we needed to get to hospital. It was frosty and her Mini wouldn't start so the MG took us to Ascot

hospital. Two weeks later it was all four of us getting back home, again in the MG as her Mini was now too small.

Last year the MGB GTV8 was used at one daughter's wedding as the bridal car. The MG at 280 miles is now approaching the status of family heirloom and where possible I now avoid poor weather. It is worth many times what I paid for it, but the money value matters less to me than the fact that one daughter wants me to put her on the insurance at next renewal. A positive sign I'm sure.

As Overseas Director I get reports from far and wide, and the common topic is how difficult it is to get younger folks involved not just in the MG world, but in all car clubs. Currently only about 1.5 percent of our membership are 24 or under. Although there are specific UK factors not shared elsewhere like new houses being built without garages due to the price of land, nevertheless it is vital that we engage fully with younger folks even if they do not currently own an MG. It is also important to fully welcome those with Chinese manufactured MGs because they too are our future. I was asked last October to place my MGB GTV8 on display at a local

main dealer's showroom alongside a visiting Cyberster. It demonstrated the pedigree of the marque, but also how far automotive technology had progressed. Many markets should be getting the Cyberster this year. It looks the business at 0-60 mph in 2.8 seconds, Ferrari performance at roughly one third of the price. I believe we are going to see quite a few of them, and one thing we do know is that sports car owners are more likely to join a club than other types of car owners.

We are coming near to the close of the Centenary year and I anticipate that Tamworth will still be celebrating. The UK MGCC wishes this 53rd National Event all the best, and thanks the MGCC of Victoria for organising and hosting.

Octagonally yours and all the best for 2025 and beyond.



SHARE THE PASSION

MG TC – 80 YEARS

The 2025 MGCCs of Australia are pleased to celebrate the 80th anniversary of the MG TC at this National Meeting.

Introduced 1945 -1949

Number built – 10,001

The MG TC Midget is probably one of the best known MGs to come out of Abingdon since the Second World War. As soon as the war was over the factory resumed car production after six years of producing tanks, armoured cars and aeroplane engines for the war effort. The basis of the new car was the pre-war MG TB, it was to have a similar engine and gearbox and axles, the only significant changes would be to the body which was widened by nearly 4" across the seats without changing the basic chassis, wings and running-boards or fascia layout. The TC was improved in detail too, the sidescreens now had flaps to facilitate hand signalling, the electrical equipment was also updated with the twin 6 volt batteries removed from the underfloor

position of the TB to a bulkhead box containing a large 12 volt battery. There were also changes to the suspension, hydraulic lever arm dampers were fitted and the road springs were mounted in shackles rather than the traditional sliding trunnions. This change allowed the use of war-proven rubber suspension bushes which gave smoother quieter feel to the car as did the fitment of rubber engine mountings. Otherwise it was exactly the same as the 1936 design of the MG TA which started the T series line. Within 5 weeks of the official end of the war in October 1945, The MG Car Company announced the TC Midget and by the end of that year had proudly produced 81 examples which was no mean feat as so many materials were in short supply, especially sheet steel.

The car sold exceptionally well, a large number were exported to Commonwealth countries, particularly Australia and South Africa, which was not surprising as MGs had sold there in quantity before the war. What was surprising however was that there was immense interest in the United States and it can be stated that

the MG TC was responsible for starting the American craze for the British Sportscar. Nearly 2000 cars were exported to the United States and Abingdon had deemed the potential sufficient to warrant the development of a special North American model, still in right hand drive form but with chrome bumpers and flashing indicators. The effect that the TC had on America was unbelievable as it introduced the pleasures of sports car ownership to people who had never experienced it before and it

opened up the market for many more imported cars to follow.

One notable customer in England for the TC was the Duke of Edinburgh who owned one before marrying Princess Elizabeth, the future Queen, in 1947. Sales were going from strength to strength which saw over 1600 produced in 1946 rising to a peak of over 3000 during 1948. In total exactly 10,000 were produced between 1945 and 1949.

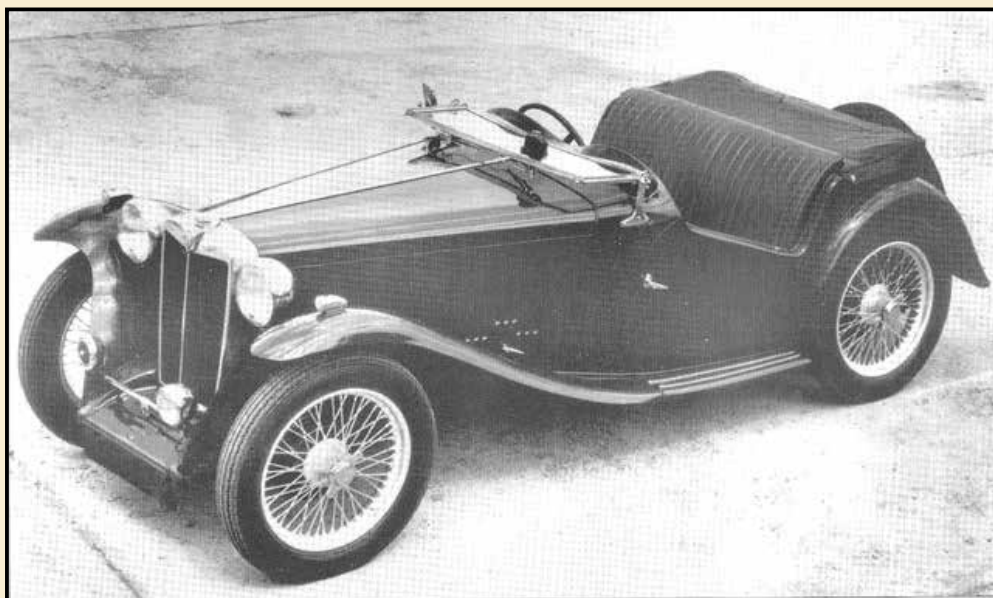

The British Racing Green MGTC owned by MGCCV member Andrew Gall is the 34th MGTC build and probably one of the oldest two MGTC's known in Australia. It was built on the 30th of October 1945.

It carries Chassis number 0285 and the original engine number 936. The chassis numbers started from 251 This was Abingdon factory's phone number!

The early history of this vehicle is unknown.

We do know it was black (only colour available) and is now British Racing Green. Phillip Badger (now passed away) purchased the car in May

1963 for 100 pounds. As daily transport for Philip and his brother until the early 1970's when it was stored away under the house. Philip and his brother restored the car

between 1997 and 2004. Philip sold the car to Andrew Gall in November 2019. It is actively used in club competition and to attend and compete at various National Meetings.

<p>SCREEN WIPER CHOKE HORN & ANTI-DAZZLE LIGHTING & IGNITION STARTER SLOW RUNNING FOG LAMP GEAR POSITIONS THROTTLE HAND BRAKE FUEL WASHING LIGHT</p> <p>Described in "The Autocar" of October 12, 1945.</p>	<p>DATA FOR THE DRIVER</p> <p>TYPE TC M.G. MIDGET</p> <p>PRICE, with open two-seater body, £412 10s plus purchase tax, £115 6s 8d, total £527 16s 8d.</p> <p>RATING: 10.97 h.p., four cylinders, o.h.v., 66.5 x 90 mm., 1,250 c.c. Tax, £13 15s (cars first registered after January 1, 1947, tax £13).</p> <p>WEIGHT, without passengers: 15 cwt 3 qr. LB. PER C.C.: 1.41.</p> <p>OVERALL GEAR RATIOS: 5.125, 6.93, 10.00 and 17.32 to 1.</p> <p>TYRE SIZE: 4.50 x 19in on knock-off wide-base wire wheels.</p> <p>LIGHTING SET: 12-volt. Automatic voltage control.</p> <p>TANK CAPACITY: 13½ gallons; approximate fuel consumption, 29.35 m.p.g.</p> <p>TURNING CIRCLE: 37ft. (L. and R.).</p> <p>MINIMUM GROUND CLEARANCE: 6in.</p> <p>MAIN DIMENSIONS: Wheelbase, 7ft 10in. Track (front and rear), 3ft 9in. Overall length, 11ft 7½in; width, 4ft 8in; height, 4ft 5in.</p>
---	---



FROM THE FRAME UP

SPECIALIZING IN TABC HARD TO FIND PARTS

 RESTORATION

 PARTS

 SERVICE



FRIDAY 18TH APRIL THE CUBE – 118 HOVELL ST, WODONGA

Registration

Times: 10.00 am to 3.00 pm

Registration will be in the main foyer, enter via the courtyard.

Your registration details will be confirmed and credentials issued. If you are a Competitor entrant, then proceed and present your car for scrutineering.

At Registration entries can be submitted for the Photographic Competition.

Pre ordered Regalia will be available for collection.

Rocker Cover Racing entrants should register at this time.

The Tie Breaker test for the Discovery Run will be completed beside The Cube's car park after Scrutineering.

Parking is available to the side and rear as well as in the surrounding streets.

Scrutineering

Times: 10.00 am to 3.00pm

Scrutineering for class compliance and general safety will be conducted in The Cube's rear car park off Havelock St.

A scrutineering form will be emailed to all competitors prior to the event. Please bring your completed self-scrutineering declaration to scrutineering with you.

A marquee will provide protection from the sun or wet weather should it occur.

Form an orderly queue as directed by the marshals.

Vehicles must be registered before they are scrutineered.

For entrants participating in the Speed Event please present helmets and fire extinguishers for inspection. Motorsport Australia Log Books and "Certificate of Descriptions" are to be presented at the same time, if applicable.

Noggin n Natter

Main Auditorium, The Cube

6.30 pm to 10.00 pm

The "Noggin n Natter" is the time to renew friendships and rivalry from previous years and make new friends.

Food will be provided, with drinks available at the bar. Tables and seating will be available as we aren't getting any younger.

Please ensure you bring your registration credentials to enable entry to the event. Wear your Club Regalia to be part of the team.



FRIDAY 18TH APRIL

THE CUBE – 118 HOVELL ST, WODONGA

Rocker Cover Racing

Main Auditorium, The Cube

Scrutineering from 6.30 pm to 7.00 pm

Racing Starts at 7.00 pm

Video coverage of the Rocker Cover Racing together with tiered seating will make the ensure excellent viewing.

The Racers:

1. The racers cannot have any power source. Gravity Only.
2. The rocker cover must be from any MG or a cover of the same silhouette.
3. The racer shall not be more than 40mm longer than the rocker cover.
4. Racers shall have 4 wheels of not more than 155mm diameter.
5. Wheel track shall not be more than 200mm.
6. Maximum weight shall not exceed 3kg.

The Course:

1. The decline will be 1.5 metres long followed by a level run of 6 metres.
2. The decline will be divided into 2 lanes each 450mm wide
3. The decline will be 600mm at its highest point and the front of the decline will be bevelled to give a smooth transition to the run-out.
4. A mechanical starting gate will be employed.
5. The run-out sector will be 2 lanes of 900 wide, clearly marked.
6. The finish line will be marked 6 metres from the front edge of the launch decline.

The Race:

1. There will be heats of 2 racers per heat.
2. The racers will start with the front wheels on the start line.

3. The first racer to have its front wheels cross the finish line is the winner. If neither racer reaches the finish line, the one travelling the furthest distance is the winner.
4. Any racer touching or crossing a lane marker shall be disqualified. The other racer becomes the winner.
5. Winning racers will advance to the next round until all are eliminated except for one which will be the outright winner.



Insure with Victoria's first car enthusiasts.



Since 1903 RACV has been taking care of car enthusiasts and their cars. So when you're looking to insure your vintage, veteran or classic vehicle, you can relax knowing RACV's policy takes care of your car almost as well as you do.

With a list of features including agreed value, retention of salvage* and a choice of repairer, you can be sure that RACV has got you covered, and with our Years of Membership Benefits program the longer you've been a member the more you'll save.

RACV Vintage, Veteran & Classic Vehicle Insurance:
For a quote call 1800 646 605 or visit www.racv.com.au

RACV

RACV Veteran, Vintage and Classic Vehicle Insurance is issued by Insurance Manufacturers of Australia Pty Ltd ABN 93 004 298 084 AFS Licence No. 227678. Please consider the Product Disclosure Statement before buying. For a copy call 13 RACV (13 7228). *Applies to total loss vehicles manufactured before 31/12/1980.

SATURDAY 19TH APRIL – CONCOURS GATEWAY LAKES, LINCOLN CAUSEWAY

Event Director – Max Irvine
0447 504 037
Chief Judge – Matthew Magilton
0403 989 852

Timetable

8.30am Site Opens
9.15am Cars in place
9.30am Judges briefing
9.45am Judging commences
12.30pm Judging finished
1.30pm Class finalists announced, Class winners line up for outright judging
2.00pm Outright judging commences
3.00pm Finalisation of judging
Event closes.

The Concours will be held at the Gateway Lakes precinct, Wodonga. The location provides a perfect backdrop for the Concours in a central parkland setting right across the road from the Gateway Village Arts precinct.



Entry to the Gateway Lakes will be from the South via Service Road. Traffic Management will be in place, limiting speed on Lincoln Causeway to 40 kph in the area.

Cars arriving from the North on Lincoln Causeway will be required to turn right into Service Rd via the traffic lights South of Lemke Rd. Those arriving from the South will turn left at the traffic lights onto Service Rd.

All cars are to be driven onto the venue and be in place by 9.15 am.

For safety reasons, you must restrict your speed to walking pace when moving within the venue. A marshal will direct you to your class on arrival. Vehicles are to remain in position throughout the event and are not to leave before 3.00 pm. Trailer parking is available in a designated area at the rear of the oval with the Visitors Parking. Trailer and visitor entry will be via a dedicated entry gate further along Lemke Rd.

Class winners will be announced on the day and award presentations for second and third places will take place at the Saturday Theme Night. First

place and outright award presentations will take place at the Presentation Dinner on Monday.

Please leave your entered vehicle unlocked with the handbrake on and your bonnet and boot raised. Your hood should be raised and side screens in place (if applicable). Care should be taken not to leave personal property and valuables in the vehicle.

The judging sheet for your car must be prominently displayed on the windscreen along with the vehicle sticker you received at Registration on Friday. No inducements, judging aids, mirrors, ramps or stands shall be permitted. Judges may ask you a question but please refrain from approaching them unless requested.

There are a few catering vans on site and directly opposite the Concours site there is an Arts Precinct. It incorporates several galleries. Take a wander via the underpass on the Albury side. The Lincoln is open for lunch, pre-booking required, to assist with staffing and catering. There is also a Middle Eastern style restaurant, La Maison.



SATURDAY 19TH APRIL

THEME NIGHT AND CONCOURS PRESENTATIONS

COMMERCIAL CLUB, 618 DEAN ST, ALBURY

Theme Party and Concours Trophy Presentations

Albury Commercial Club, Auditorium

6.30 pm to 10.30 pm

Theme: **Flappers, Gangsters and all that Jazz**

Please note that as this is a NSW Licensed Premises, you may need to sign into this venue, just in case bring your licence.

The Auditorium is on level 1 up the wide staircase from Elizabeth St. A lift is adjacent to the staircase. Entry points conveniently situated at **Elizabeth** and **Stanley Street** providing easy access to the Club.

The Albury Commercial Club, provides our members and guests with complimentary onsite

parking. Both multi-story and underground covered parking options are available, accommodating over 800 vehicles.

Pre-dinner drinks are available at the foyer/bar adjacent to the Auditorium.

A three-course meal will be provided with drinks on the table to start, additional drinks are available to purchase at the bar.

Presentation of Concours Awards throughout the evening.

The Outright winners will be announced at the Presentation Dinner.

Please bring your registration credentials to ensure entry.



www.autosurplus.com.au
 Unit 18, 114 Merrindale Drive, Croydon South VIC 3136
 03 9873 3566 | sales@autosurplus.com.au

SUNDAY 20TH APRIL – MOTORKHANA

WINTON MOTOR RACEWAY, HUNTLEY STREET, WINTON

Event Clerk of Course – John Hastie
0400 801 320

Asst. Clerk of Course – Torquil Kelso
0417 398 606

Getting there and parking

Winton is approximately 1 hours drive from Wodonga along the Hume Highway. Head south on the Hume Hwy out of Wodonga and take the Benalla/Shepparton exit (C313). At the round-about, take the first exit towards Winton on the Winton-Glenrowan Road. Turn right at 1.7km on to Huntley Street (DO NOT turn right on to Fox Street).

Once entering the venue, turn left at the T intersection and park on the large grassy area beside the toilet block. This is the area for all parking for officials, spectators, tow cars, trailers and competitors' cars.

Drivers' Briefing & Event Format

Attendance at your drivers briefing is mandatory and you must sign on. This will be held in the dummy grid area. It is your responsibility to remove all loose objects from the interior of your car BEFORE you line up in the dummy grid. Scrutineering spot checks will be carried out randomly during the event. Moving around the venue must be at walking pace and marshals will direct the traffic flow.

Each competitor will have two (2) runs at each test, only the fastest to count. The three tests will be run consecutively as per the course plan and at the completion of your third test, you will return to the carpark and wait until all competitors within your group have had their first run, at which point the second runs will commence. Please line up in car number order within your class. If double entered, ensure the timekeepers are aware of your number to prevent errors. Double entered cars may run out of sequence.

Timing

Timing will be electronic with large displays at each pattern, backed up by handheld stop watches.

Catering / Fuel

A coffee and food van will be on site. Fuel will not be available at Winton. The closest petrol stations are located at Benalla, 10 minutes away.

Spectators

There is a safe area for spectators, however there is no seating and no shelter, so BYO chair and appropriate attire for the conditions.

Event Times

Group 1: Classes A, B, C, D, E, F, G, H, I, J & K
Drivers' Briefing: 8:15am Start: 8:30am

Group 2: Classes L, M, O, P, Q, R, S, T, U, V, W & X
Drivers' Briefing: 10:45am Start: 11:00am

Group 3: Classes Y, Z, ZA, ZB, ZC, ZD & ZE
Drivers' Briefing: 1:15pm Start: 1:30pm

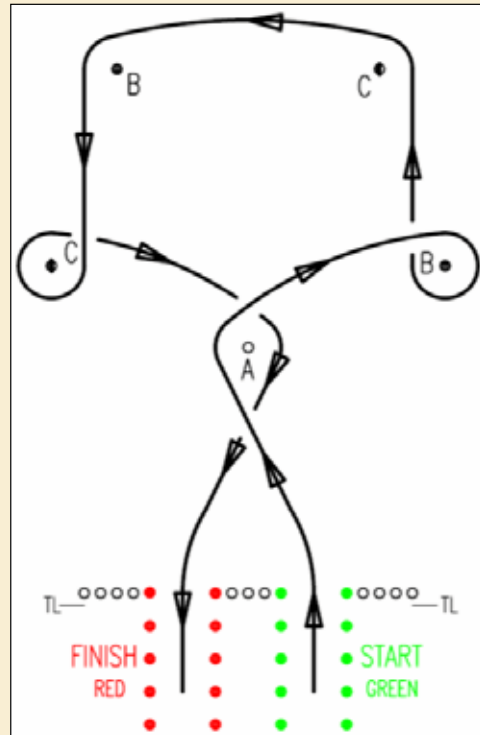

Bowler Hat

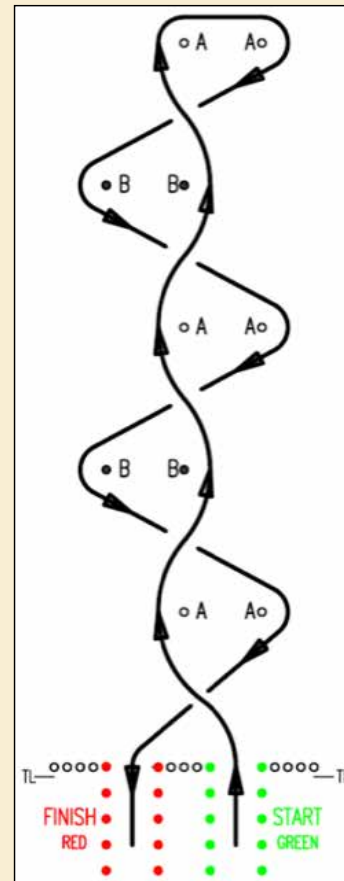

Gate Slalom

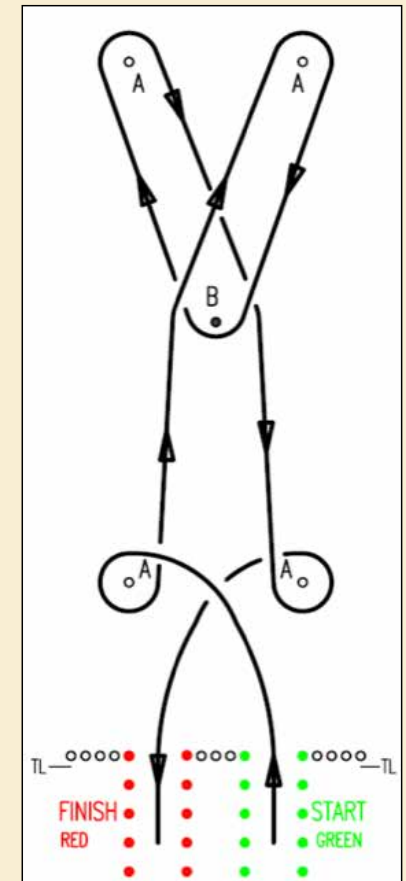

Double Hat (Rev)



SUNDAY 20TH APRIL

KIMBER RUN, HUME WEIR – 10.00AM

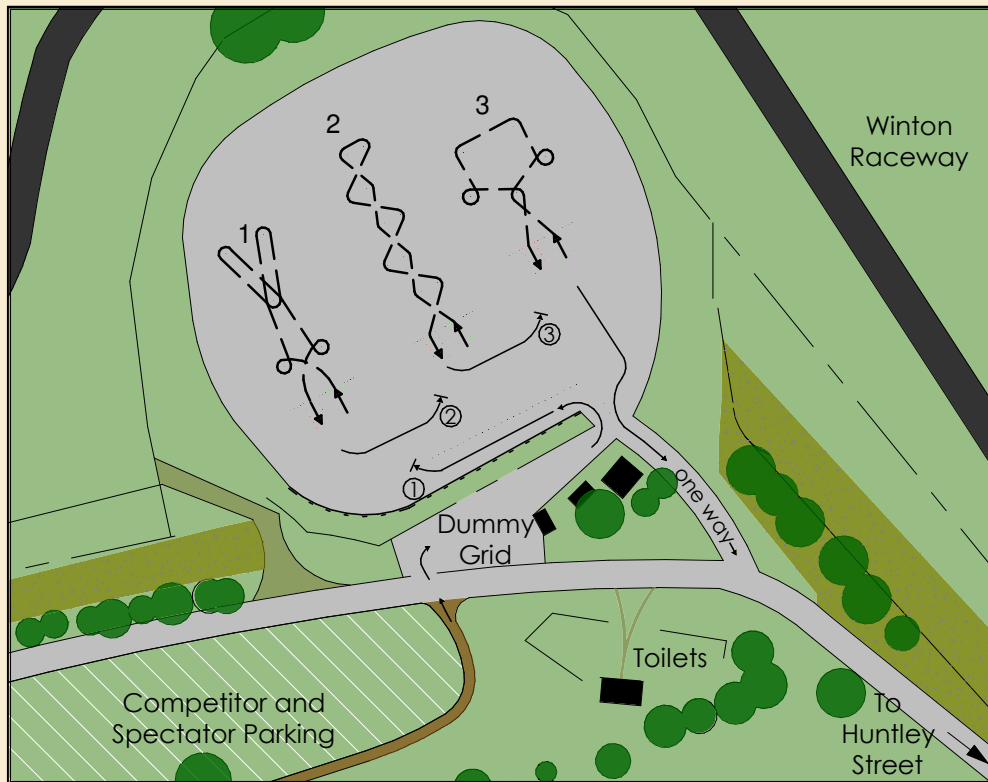

Location: Hume Dam, end of Murray Street, Lake Hume Village

Allow 20 minutes plus from Albury to the start.

Arrive Hume Dam: 10.00am – 10.15am

Staggered start: 10.10 am – 10.30am

Contacts: Reg and Mary Bowran 0412 189 852

The Kimber Run is a social drive of around 235km/145miles through Victoria's picturesque North-East river valleys and hill country. Driving time is around three hours plus your time for exploring. It is anticipated that most participants will not have previously driven much of the first 160km.

The route will go east along the northern Murray arm of Lake Hume, across the less travelled Granya link to the Murray Valley Highway then west along the Mitta Mitta arm and down the Kiewa Valley to Running Creek, avoiding the Kiewa Valley Highway.

Some winding roads through scenic hills leading down to the Ovens Valley where your complementary pre-ordered lunch will be available at The Happy Valley Hotel Ovens.

The second leg, towards home, is an easy drive allowing plenty of time to visit Myrtleford and the pretty village of Yackandanda, and perhaps a coffee or one glass of delicious local wine.

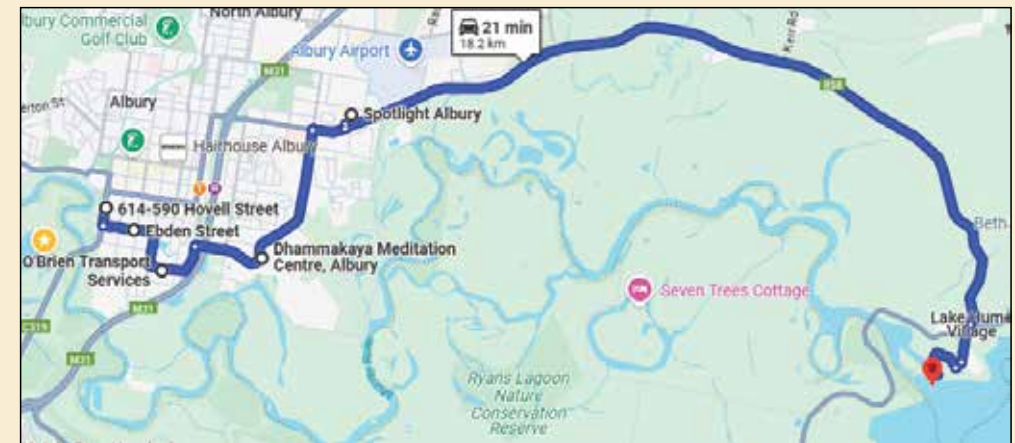

Modified Hi-Torque "Gold Spark" Starter Motors

Suits all TC, TD, TF, MGA, and all MGB models except V8 engined cars
MGB & TF, and specials made to order

- * Reduction geared - gives 200% more cranking torque
 - * Uses 50% less power than original starter
 - * Compact, lightweight & 50% lighter than original, weighs only 7 lbs
 - * Prices from \$375 & \$20 postage
- Designed to start an engine regardless of compression,
or engine temperature



Call Doug Hastie 0418 541 326, email dfshastie@gmail.com

MONDAY 21ST APRIL – SPRINT LOGIC CENTRE, BARNAWATHA

Event Clerk of Course – Torquil Kelso
0417 398 606

The circuit is sealed bitumen track 1.6 kms long and 11 metres wide. The track is operated in an anticlockwise direction. The event will be run in two sessions.

Competitors in Classes A to Q will run in the morning session and those in **Classes R to ZZ** in the afternoon session.

The commencement times for the various activities are listed below.

Entrants need to ensure they arrive in plenty of time, so they are ready to attend the driver briefing and have their car and themselves ready to compete. Ensure all loose items are removed from your car on arrival and forward-facing glass on lights is covered. Random checks on car safety compliance and driver apparel will occur during the day.

A **compulsory driver briefing**, by the Clerk of Course, for the morning session will be held at 7:15 am and for the afternoon session at 11:15 am.

Competitors in each session will be seeded into Groups of up to eight(8) based on past performance, where known, to minimize overtaking. You will be advised of your Group allocation and position in your Group at Registration. It is envisaged that each entrant will

receive three (3) separate 10-minute sessions on the track including warmup and cool down laps.

Groups will be called to the marshalling area in sequence and assembled in the grid lane as soon as the preceding Group enters the track. Group order maybe reorganised, after the first Run, based on performance. The fastest lap recorded by the competitor on the day will decide their placing in the competition.

Timing will be done using Dorian transponders. Competitors are to collect their Dorians from the official at the event on arrival and ensure they are securely fixed to their cars prior to the driver briefing. Instructions for fixing Dorian transponders to your car using a polypropylene shopping bag have previously been forwarded to competitors and are also available from officials on the day.

A coffee and food van will be on site. Fuel is not available on site but there is a BP service station 1 km before the facility.

Driver briefing – morning session 7:15 am

Competition commences – morning session 8:00 am

Driver briefing – afternoon session 11:15 am

Competition commences – afternoon session 12:30 pm

The Lap Dash/Super Sprint Event will be held on Easter Monday at the **Wodonga Tafe Driver Training Complex** in Barnawartha North. This is a 15-minute drive down the Hume Highway from central Albury.

There is a large BP service centre a few minutes from the Training Complex

The freeway exit is marked **“Yarrowonga B400”**. After the exit, stay right where signposted **“B400 Yarrowonga”**, and cross over the freeway, then proceed 1km along **B400** to a roundabout. Turn left down **“Logic Boulevard”**, and drive 350m to another roundabout. Turn right into **“Albertson Road”**, and drive 500m to the complex entrance gate. Proceed straight ahead through a raised boom gate, and follow the road towards the track.



Cars can be unloaded in the areas marked **“Trailer Park”**, then moved into the **Pit Area**.



Note the "TRACK ENTRY" and "TRACK EXIT" arrows from and to the pit area.



MONDAY 21ST APRIL DISCOVERY RUN AND SOCIAL SCENIC TOUR

**Contacts – June Rushton 0416 298 208
Wayne Rushton 0412 339 934**

THE COMPETITIVE DISCOVERY RUN EVENT

An interclub touring event on public roads conducted within Victorian Road Laws, following a prescribed route. Route instructions for the first section will be issued at the commencement of the event. Subsequent instructions will be issued along the route, and questions issued only after entrants are parked and out of their cars.

The commencement point for the Discovery Run is at Gateway Lakes. The tiebreaker test will be conducted at Registration next to The Cube car park.

TIMING

- 8.15am Cars start arriving Gateway Lakes
- 9.00am Driver's Briefing
- 9.30am Discovery Run competitors start leaving
- 2.30pm Discovery Run concludes
Those arriving after this time may be disqualified.

THE DISCOVERY RUN

Takes approximately 2.5 hours and is no more than approximately 140 kms. There are many inviting places to have a coffee along the way. Complimentary morning tea will be provided at a designated location. Lunch venues can be found in several towns and wineries along the way. This is not a race and the quickest time won't necessarily win.

NOTE:

Following a change in Australian Motorsport Rules, questions will no longer to be made available while cars are in motion.

At the start of the event, participants will be given directions only to the first Control Location. Upon arrival at the Control, participants will be required to park their vehicles and report to Control Officials.

Discovery Run participants will then receive a Question Sheet for that location. Once completed, it should be returned to the Control Official, where they will then receive directions to the next Control Location. This process will continue until the run concludes.

This event procedure is established to ensure that no observations are made or questions answered while driving.

Scenic Social Run Participants will not receive the questions.

SOCIAL SCENIC TOUR

The Social Scenic Tour is a social drive following the same route as the Discovery Run. The commencement point is Gateway Lakes the same as the Discovery Run.

- 9.30 am Social cars arrive at commencement point
- 10.00am Social cars start to leave

Scenic Social Tour participants will not receive the questions.

Please enjoy the sights and stop for coffee, visit a winery and stop for lunch along the way. Complimentary morning tea will be provided at a designated location.



MONDAY 21ST APRIL – PRESENTATION DINNER

SS&A CLUB, 570/582 OLIVE ST, ALBURY

Auditorium, Level 1
SS&A Club Albury
7:00pm – 11:00pm

Please note that as this is a NSW Licensed Premises, you may need to sign into this venue, just in case bring your licence.

Parking is off David Street. Full lift access is available.

The final event of the 2025 National Meeting is a semi formal event. This is an evening to

celebrate your achievements over the 2025 National Meeting.

The Presentation dinner includes a three course meal with complementary bottle of wine and soft drink for each table. A bar for the purchase of additional drinks is available.

Seating will be tables of ten by Club Centres.

Please bring your registration credentials to ensure entry.

TUESDAY 22ND APRIL

FAREWELL BREAKFAST & DELEGATES MEETING

Skylight Lounge, Level 1
SS&A Club Albury
7:00 am – 10:00 am

Address: 570/582 Olive Street, Albury

Buffet breakfast (including hot dishes) is available.

Please bring your registration credentials to ensure entry.

Delegates Meeting

The delegates meeting will be held in the SS&A Club, Ground Floor, Executive Meeting Room. Adjacent to Olive St entrance.

The Worlds Most Proven Petrol Octane Booster and Lead Replacement

95 **98**

X-1R **NO.1** IN INTERNATIONAL SURVEY

OCTANE BOOSTER

Car Club Members Exclusive Offer 25% OFF RRP

E: sales@burgdesign.com.au - www.burgdesign.com.au - Ph:03 95559277

MGB - MGB GT - MGF - MG TF
MG MIDGET - MG ZR
MG ZS - MG ZT - MONTEGO - MAESTRO

ALL THE PARTS YOU NEED

FROM THE SMALLEST NUT & BOLT TO AN ENTIRE BODY SHELL & EVERYTHING IN-BETWEEN

QUALITY PARTS & ACCESSORIES

FAST & RELIABLE WORLDWIDE DELIVERY

EXTENSIVE WEBSITE

VAST STOCKS AT 100,000 SQ FT HQ

KNOWLEDGEABLE STAFF

FREE COMPREHENSIVE CATALOGUES

ASK US FOR A FREE CATALOGUE

PRICE MATCH

TRADE & WHOLESALE ENQUIRIES WELCOME

WEB - www.rimmerbros.com
 EMAIL - sales@rimmerbros.com
 TEL - +44(0)1522 568000

SEE OUR SOCIAL MEDIA

Rimmer Bros., Triumph House, Sleaford Road, Bracebridge Heath, Lincoln, LN4 2NA.

RULES & REGULATIONS

Anti Doping Policy

Use of Prohibited Substances

During any event, consumption of alcoholic beverages in the paddock, pits or any other portion of the competition venue under the control of the officials is expressly forbidden. until all practice or competition activity is concluded for each day. Any driver or crew member who is found to be effected by alcohol on the day of the event or practice therefore shall not be permitted to participate. In addition, the persons concerned will be subject to the Articles of the Procedure for Alcohol Testing and Motorsport Australia (MA) Anti-Doping Poicy. Competitors, crews or officials may be tested for alcohol or other drugs at any time during the events. This regulation serves as the required 24-hour notice to Competitors, Crew and Officials.

Other Prohibited Substances

The MA Drugs in Sport Policy, as appears in the MA Manual of Motorsport and as amended from time to time, is recognised as an integral component of the NCR and is duly authorised as such. In any areas where the National Competition Rules and the drugs in Sport Policy conflict, the Drugs in Sport policy will take precedence. There must be no alcohol in pit or paddock areas at any time.

Insurance

Public Risk Insurance has been effected by the Promoter (MG Car Club Victoria) through MA. All drivers, all signed on crew, and all signed on officials at all events are covered by MA personal accident policy through the event permit and possession of a valid competition or officials licence.

Safety

Speed Event

Drivers must wear a helmet to a standard listed in the MA Manual of Motorsport, and be deemed by the scrutineers of the event to be in a suitable condition for motorsport use, non flammable clothing, suitable footwear and, in open cars, goggles or visors with lens other than glass. (Schedule D of the MA Manual of Motorsport).

Equipment

MA regulations state that all cars competing in the Sprint will be required to be fitted with approved seatbelts or harnesses. These belts are to be in good condition and fitted in a workmanlike manner.

Cars shall be fitted with a Fire Extinguisher that is either new or has been serviced within the last three years.

Motorkhana

Special attention will be given to:

1. removal of all loose objects from the vehicle
2. minimum 'lap' seat belts are required
3. suitable footwear
4. prohibited: open-toed shoes or thongs.

Noise

All competing cars must be fitted with a device that restricts the exhaust noise level to a maximum of 95db (A) measured at a distance of 30 metres on a drive-by test under full acceleration. vehicles may be tested during competition on the day. Any competitor's car which exceeds this limit will be warned. A second offence will result in expulsion from the remainder of the event.

AWARDS & TROPHIES

Perpetual Trophies

John Wratten Memorial Trophy

Nuffield Oceania Trophy

Jean Kimber-Cook Perpetual Trophy for Junior Drivers

Joan Richmond Trophy

Chris Dodds memorial trophy

New Zealand Plate

Golgen Gudgeon Trophy

Cecil Kimber Centennial Trophy

The TC Owners Club Perpetual Pre-War Plate

The Ian Curwen Walker Trophy

National Magazine Trophy

National Website Trophy

Other Trophies

Outright Concours Pre MGA Trophy

Outright Concours Post MG TF Trophy

Outright Speed Event Trophies

Outright Motorkhana Trophies

Outright Discovery Run (former Observation Run) Trophies

Hard Luck Trophy

Photographic Trophies

Rocker Cover Racing Trophies

Awards

Trophies will be presented to 1st, 2nd and 3rd placegetters in each class in each competition. In the case of perpetual trophies, there must be a minimum of two competitors/drivers in the class in each competition event before a competitor in that class can be considered for an award. The organisers reserve the right to make additional awards.

In the case of a tie, the entrant who competes in the larger class will be declared the winner. The class size will be determined by the number of Concours entrants per class.

Points Allocation- all Competitive Events

9 points - 1st place in each class/event

6 points - 2nd place in each class/event

4 points - 3rd place in each class/event

3 points - 4th place in each class/event

2 points - 5th place in each class/event

1 point - 6th place in each class/event

John Wratten Memorial Trophy

Presented as a perpetual award at the first National Meeting in Sydney in 1970, by the Sydney MG Dealer. At the second National Meeting in Melbourne in 1971, John Wratten was tragically killed in an accident at Calder in a P-Type. John was secretary of the Victorian Centre and one of the organisers of the National Meeting. It was unanimously agreed at the Delegates Meeting after the event that in future this MG trophy would become the John Wratten Memorial Trophy.

It is presented to the Club obtaining the most points over all the four competitive events, adjusted by the "Fudge Factor". Points will be allocated for this trophy as detailed below, regardless of class size. In the case of tied places, both competitors will receive the points applicable to the placing.

Nuffield Oceanic Trophy

Early in the 1950's Lord Nuffield commissioned and presented four prestigious trophies to the MG Car Club UK so that they would recognise the achievements of the overseas centres in four separate regions. These regions were:

1. Europe
2. South Africa
3. United States
4. Oceania

The Oceana Trophy was awarded to various Australian and New Zealand centres until 1960. In 1961 the Home Centre decided to review the award criteria but during the review period a key person left the team and the project was

forgotten and the cup was placed into secure storage in Melbourne. In 1995 the combined Australian MG Clubs agreed to a set of locally written rules which were then approved by Mike Hawke Chairman, and Alan Kingwell, Overseas Director of the MG Car Club Home Centre, while attending "MGs Down Under" in Fremantle and the trophy was given to the Australian MG Car Clubs for their use. This award is based on the Concours and Motorkhana only and each Club is represented by two percent of their nominated MG ownership numbers. A minimum of five and maximum of 20 shall be used for averaging. The total points scored by the Club's two percent shall be calculated then averaged. The resultant average shall be the measure of the Club's performance. The winner is the Club with the highest average score.

Jean Kimber-Cook Perpetual Trophy for Junior Drivers

Jean Kimber-Cook was in Fremantle in 1995 and presented Harry Pyle with a scale model of an MGTC which was mounted on a trophy to recognise the most successful Junior competing at the National Meeting. The trophy is awarded for the best score by a Junior in the Motorkhana Event Entrants must be under 17 at 1st January 2025 and nominate their participation at time of registration.

Joan Richmond Trophy

Initiated and donated by the MG Car Club Victoria in 1989, this trophy is awarded to the female entrant who achieves the highest aggregate score over all competition events during the National Meeting. The trophy is named in recognition of Joan Richmond, an Australian sportswoman who achieved International recognition in motorsport and was part of the 1935 MG woman's team at Le Mans.

Chris Dodds Memorial Trophy

Inaugurated by a gathering of the V8 Register members at the 1982 National Meeting in Canberra the trophy was donated in recognition of Chris Dodds' contribution to the MG marque and in particular the V8 Register. Chris passed away in December 1981 at age 28 and an annual trophy in his honour is competed for both in the UK and Australia. The Chris Dodds Trophy

is awarded to the entrant with an MGB GT V8 Class scoring the highest aggregate points over the National Meeting weekend.

New Zealand Plate

The New Zealand Plate was first presented at the 1977 National Meeting held in Katoomba. It was brought to Australia by a group of enthusiasts from New Zealand led by Bill and Gaye Baxter. It is awarded to the entrant with a T Type with the best aggregate points score- Classes D, E, F and T Types in Class X.

Golden Gudgeon Trophy

Instigated at the 1978 National Meeting in Perth by the Australian T Series Association, the trophy is presented to the entrant with a T Type achieving the best aggregate score- Classes D, E, F and T Types in Class X. Note that Class Z Super Specials are not included for this trophy.

Cecil Kimber Centennial Trophy

Cecil Kimber's daughter, Jean Kimber Cook, brought this trophy to Australia in 1988 from the MG Car Club in the UK. It is awarded to the individual competitor attaining the highest points in all events. All events judged equally.

The TC Owners Club Perpetual Pre-War Plate

Donated by the TC Owners Club to recognise the efforts of the owner of a Pre-War MG. It is awarded to the driver of the Pre-War MG attaining the highest point score in competition.

National Magazine Competition Trophy

Donated by Gosford Shoplifters in 1982. The trophy is awarded to the Club judged to have the best magazine. Factors taken into consideration are presentation, content, cost and quantity printed.

National Website Competition

The Perpetual Award is donated by the Geelong MG Car Club. Judged by an independent IT Consultant.

Photographic Competition

Entries for this competition are displayed throughout the National Meeting weekend. Photographs are the entrant's own work and taken within the last two (2) years - all feature an MG theme or cars and have not been displayed at a previous National Meeting.

Categories Judged are:

1. Best Action photograph
2. Best Still photograph
3. Best Novelty photograph
4. Best Creative Digitally-enhanced photograph

A trophy for first place in each category only, will be awarded. All entries must be supplied as prints, maximum size of photograph is restricted to A4.

Hard Luck Trophy

Although not a perpetual trophy, it is a custom at MG National Meetings to present a small token award to a National Meeting participant who has had the misfortune to suffer a mishap on the way to the National Meeting. There have been many extraordinary tales over the years and often it is a difficult task for the host centre to decide who is the most deserving of the Hard Luck Trophy.

The Ian Curwin Walker Trophy

This trophy is awarded to the male who achieves the highest aggregate score over all competition

events. (Fudge factor not included.) This trophy honours one of the foundation members of the MG Car Club of SA and well known National Meeting participant. Awarded in 2023 by the MG Car Club of South Australia.

The Fudge Factor

The Fudge Factor takes into account the distance travelled by members of a Club to the National Meeting and the number of MG owning members as at 31st December of the preceding year. MG owning membership is defined as up to three members of a family (over the age of 18 years) being attributed to one MG car. It is used in calculating the inter-centre points for the following trophies only:

- John Wratten Memorial Trophy
- TC Owners Club
- Golden Gudgeon Trophy.

Note: Distance is calculated from the registered address of the Club to the event using the shortest route from www.whereis.com.

Centre	Distance	MG members	Fudge Factor	2% factor
MGCC Canberra	355	211	1.91	5
MGCC Geelong	387	310	1.83	6
MGCC Gold Coast	1386	248	3.61	5
MGCC Hunter	686	133	2.72	5
MGCC Newcastle	685	135	2.71	5
MGCC NSW	555	573	1.90	11
MGCC Queensland	1383	352	3.39	7
MGCC South Australia	867	948	2.19	18
MGCC Sunshine Coast	1506	175	4.08	5
MG TC Owners Club	3389	108	8.29	5
MGCC Tasmania	1526	375	3.59	7
MGCC Victoria	330	1642	1.35	20
MGCC WA	Unknown	Unknown	Unknown	Unknown
MGCC Wagga Wagga	133	81	1.85	5
MG Restorers' Association	559	45	3.19	5
MG T Types Owners and Restorers	Unknown	Unknown	Unknown	Unknown

PREVIOUS WINNERS

Year	Host Club	Location	John Wratten	Nuffield Oceanic
1970	New South Wales	Sydney	New South Wales	
1971	Victoria	Melbourne	Victoria	
1972	South Australia	Adelaide	South Australia	
1973	New South Wales	Oran Park	New South Wales	
1974	Victoria	Melbourne	Victoria	
1975	South Australia	Adelaide	Western Australia	
1976	Tasmania	Launceston	Victoria	
1977	New South Wales	Katoomba	New South Wales	
1978	Western Australia	Perth	South Australia	
1979	Victoria	Ballarat	Victoria	
1980	Gold Coast	Gold Coast	South Australia	
1981	South Australia	Glenelg	Victoria	
1982	New South Wales	Canberra	South Australia	
1983	Victoria	Geelong	South Australia	
1984	Tasmania	Hobart	South Australia	
1985	Newcastle	Newcastle	Victoria	
1986	South Australia	Adelaide	Victoria	
1987	Western Australia	Perth	Victoria	
1988	Canberra	Canberra	Victoria	
1989	Victoria	Shepparton	Victoria	
1990	Queensland	Brisbane	Tasmania	
1991	New South Wales	Nowra	Victoria	
1992	Tasmania	Launceston	Victoria	
1993	South Australia	Adelaide	Tasmania	
1994	Hunter Region	Newcastle	New South Wales	
1995	Western Australia	Fremantle	Victoria	
1996	Victoria	Shepparton	Victoria	South Australia
1997	Gold Coast	Gold Coast	New South Wales	South Australia
1998	Tasmania	Hobart	New South Wales	Tasmania
1999	New South Wales	Gosford	Victoria	Newcastle
2000	Newcastle	Newcastle	Queensland	Queensland
2001	Canberra	Canberra	Queensland	Queensland
2002	South Australia	Adelaide	Victoria	South Australia
2003	Victoria	Shepparton	Victoria	Queensland

Year	Host Club	Location	John Wratten	Nuffield Oceanic
2004	Queensland	Warwick	Victoria	Queensland
2005	Hunter Region	Maitland	Victoria	Queensland
2006	Tasmania	Launceston	Queensland	Tasmania
2007	Gold Coast	Gold Coast	Victoria	Queensland
2008	New South Wales	Tamworth	Queensland	Queensland
2009	Victoria & Geelong	Geelong	Queensland	Queensland
2010	South Australia	Adelaide	Queensland	Queensland
2011	Newcastle	Newcastle	Queensland	Queensland
2012	Tasmania	Hobart	Victoria	Victoria
2013	Queensland	Toowoomba	Queensland	Queensland
2014	Gold Coast	Ballina	Not Awarded	Not Awarded
2015	Victoria	Yarra Valley	Queensland	Newcastle
2016	MG Car Clubs of WA	Perth	Queensland	Western Australia
2017	South Australia	Adelaide	Queensland	Tasmania
2018	Tasmania	Cradle Coast	Victoria	Tasmania
2019	Queensland	Redland Bay	Victoria	Queensland
2020	Meeting Cancelled due to Covid 19 Virus Pandemic			
2021	Meeting Cancelled due to Covid 19 Virus Pandemic			
2022	Newcastle	Lake Macquarie	Victoria	Newcastle & Hunter Region
2023	South Australia	Glenelg	Victoria	Newcastle
2024	New South Wales	Tamworth	Victoria	Victoria

KAS Kilmartin Automotive Sheetmetal Pty. Ltd.

Since 1982, we have expanded the total range of products we manufacture to over 800 parts and categories. **Austin-Healey, MG and Triumph.** Our extensive range of quality chassis repair sections, body repair panels and trim parts are made with an emphasis on originality. We supply parts to anyone from the one off local restorer to the large scale trade houses. Whether your car be a MGTC-TD-TF, MGA, MGB or Midget, we have the right panel for you.

Closing Down Sale

We provide you a part with the right shape and fit. We use a combination of traditional techniques and latest technology to provide you the very best product for your restoration.

3 Laidlaw Drive, Delacombe, Ballarat, Vic, 3356

Phone: 03 5335 6940

Email: kilmartin@inet.net.au Web: kas-kilmartin.com.au

COMPETITORS

Name	Centre	Entrant Number	Year	Model	Colour	C	M	S	DR	KR
Class A - Pre-war Touring MG's- Vintage S V & W & 4 seater Midgets Magnas & Magnettes										
Harry Hickling	Vic	245	1937	SA	TBA	Y				Y
Harry Hickling	Vic	246	1938	SA	Red/Black	Y				Y
Class B - Pre-war. All MG's under 1000cc including Supercharged & cars not in Class A										
Elliot Burns	HR	214	1934	PA	Oxford Blue	Y			Y	Y
Class C - Pre-war All MG's over 1000cc including Supercharged & cars not included in Class A										
Ros Bastian	NSW	275	1937	TA	Yellow over Green	Y				Y
Robert Bazzica	SA	88	1934	KN	Black/Red	Y				Y
Class D - MGTC										
Ian Duffin	Vic	206	1949	TC	Green		Y			
Andrew Gall	Vic	97	1945	TC	British Racing Green	Y	Y	Y		
Tim Grant	Tas	63	1949	TC	Red	Y	Y		Y	
Ian Nelson	Vic	215	1947	TC	Green	Y			Y	Y
Delia Rayment	Qld	321	1948	TC	Red		Y	Y		
Peter Rayment	Qld	320	1948	TC	Red	Y	Y	Y		
Geoffrey Ross	Gee	7	1949	TC	Shires Green					Y
Class E - MGTD										
Rhys Alexander	Vic	12	1951	TD	British Racing Green	Y			Y	Y
Jason Edwards	SA	66	1952	TD	Ivory	Y	Y	Y		
John Hastie	Vic	30	1950	TD	Clipper Blue	Y	Y	Y		
Tricia Ziemer	Vic	219	1953	TD	Black	Y			Y	Y
Class F - MGTF										
Neil Hawthorn	Vic	196	1954	TF	Almond Green	Y			Y	Y
Ian Jenkins	Vic	160	1954	TF	Ivory	Y	Y	Y		
Matthew Magilton	Vic	71	1955	TF	Birch Grey	Y	Y	Y		
Class G - MGA Roadster (Single Cam)										
Graham Aldous	TCOC	23	1960	MGA	British Racing Green	Y			Y	Y
Mathew Barker	Gee	5	1957	MGA	White		Y	Y		
Gavin Brown	Tas	291	1958	MGA	Red	Y				Y
Don Fraser	Tas	36	1950	MGA	Green	Y	Y	Y		
Andrew Gowans	HR	194	1962	MGA	Red	Y			Y	Y

Note: The competitor and entrant entries were correct at the time of publication.

Name	Centre	Entrant Number	Year	Model	Colour	C	M	S	DR	KR
Class G - MGA Roadster (Single Cam) (cont.)										
Frans Henskens	HR	230	1962	MGA	Chariot Red	Y				
Cameron Howie	Tas	34	1956	MGA	Green	Y	Y	Y		
Leo Pinczewski	HR	236	1962	MGA	Signal Red	Y				
Russell Seymour	Vic	56	1956	MGA	Red	Y	Y	Y		
Barry Simons	Gee	177	1957	MGA	White	Y	Y	Y		
Karen Stephenson	SA	224	1960	MGA	Green		Y	Y		
Murray Stephenson	SA	204	1960	MGA	Green	Y	Y	Y		
Class H - MGA Twin Cam Class										
Barry Beaumont	Vic	267	1960	MGA Twin Cam	Red	Y				Y
Col Cleaver	Tas	25	1959	MGA Twin Cam	Orient Red	Y				Y
Steve Foster	Wag	217	1959	MGA Twin Cam	Iris Blue	Y	Y	Y		
Ian Prior	Vic	44	1959	MGA Twin Cam	Blue	Y		Y		Y
Bob Somerville	Vic	14	1959	MGA Twin Cam	White	Y	Y	Y		
Class I - MGA Coupe (Single Cam)										
Dan Casey	GC	15	1958	MGA Coupe	Black					Y
Ric Collett	Vic	57	1957	MGA Coupe	Black	Y	Y	Y		
Peter Fynmore	Vic	26	1959	MGA Coupe	White	Y				Y
Bill Heraghty	Qld	58	1958	MGA Coupe	Midnight Blue	Y			Y	Y
Phillip Redhead	New	221	1961	MGA Coupe	Alamo Beige	Y	Y		Y	
Martin Terry	SC	250	1960	MGA Coupe	Dove Gray	Y				
Class J - MGB Mk I (Pull out door handles)										
Ray Edwards	Qld	45	1965	MGB Mk I	Sky Blue	Y	Y	Y		
Class K - MGB Mk I (Push button handles)										
Dave Burns	Can	278	1967	MGB Mk I	Malmo Green	Y				Y
Vincent Capicchiano	Vic	4	1969	MGB Mk I	Sandown Red	Y	Y		Y	
Les Clarke	GC	123	1967	MGB Mk I	White	Y	Y	Y		
Ron Hutton	Wag	283	1967	MGB Mk I	Red	Y				
Grant Leddie	HR	200	1966	MGB Mk I	Sky Blue	Y			Y	Y
Jane Miliado	SA	243	1968	MGB Mk I	Red	Y				Y
Gray Reynolds	Vic	130	1967	MGB Mk I	Nurburg White	Y	Y	Y		
Paul Slawinski	Vic	10	1966	MGB Mk I	Red	Y	Y	Y		
Joanna Smith	Vic	110	1966	MGB Mk I	Red		Y	Y		

Note: The competitor and entrant entries were correct at the time of publication.

Name	Centre	Entrant Number	Year	Model	Colour	C	M	S	DR	KR
Class K - MGB Mk I (Push button handles) (cont.)										
Alessandra Walker	Qld	172	1967	MGB Mk I	Sky Blue		Y	Y		
Graeme Walker	Qld	251	1967	MGB Mk I	Sky Blue	Y	Y	Y		
Class L - MGB Mk II										
Marjorie Halford	Vic	28	1969	MGB Mk II	Jet Red	Y	Y	Y		
Pamela Haynes	Vic	102	1970	MGB Mk II	Red	Y		Y		
Geoff Glasson	SA	520	1970	MGB Mk II	Red	Y				Y
Heather Thomson	Vic	295	1969	MGB Mk II	British Racing Green	Y				
Peter Richards	Tas	264	1968	MGB Mk II	Clipper Blue	Y				Y
Alan Wylie	HR	209	1969	MGB Mk II	Jay Blue	Y			Y	Y
George Wylie	HR	228	1969	MGB Mk II	Jay Blue				Y	Y
Class M - MGB BL & Later										
Tony Lansdell	Vic	73	1971	MGB BL	Camino Gold	Y	Y	Y		
Les Mervin	Gee	265	1972	MGB BL	Red	Y				Y
Greg Mouritz	Vic	111	1972	MGB BL	Red	Y	Y	Y		
Denis Thomas	Qld	210	1970	MGB BL	British Racing Green	Y			Y	Y
Class N - MGB Rubber Bumper										
Alan Cardnell	SA	148	1978	MGB Rubber Bumper	Tahitian Blue	Y		Y		Y
Peter Hillyer	Wag	299	1980	MGB Rubber Bumper	Bronze	Y				
Anthony Nimmo	Vic	303	1979	MGB Rubber Bumper	Red	Y				Y
Michael Salt	Qld	16	1979	MGB Rubber Bumper	White	Y				Y
Lloyd Thomson	Qld	78	1978	MGB Rubber Bumper	Red				Y	Y
Class O - MGB GT Mk I & Mk II										
Gregory Bann	Tas	74	1968	MGBGT Mk II	Red	Y	Y	Y		
Paul Harrison	NSW	253	1968	MGBGT Mk II	Snowberry White	Y				Y
Kay Herlihy	Vic	50	1968	MGBGT Mk II	Damask Red	Y	Y		Y	
Peter Hunt	Vic	242	1968	MGBGT Mk II	White	Y				Y
Torquil Kelso	Vic	235	1967	MGB GT Mk I	Grampians Grey	Y				

Note: The competitor and entrant entries were correct at the time of publication.

Name	Centre	Entrant Number	Year	Model	Colour	C	M	S	DR	KR
Class O - MGB GT Mk I & Mk II (cont.)										
Stephen Spong	SA	256	1969	MGBGT Mk II	White	Y				Y
Nick Wood	Gee	1	1969	MGBGT Mk II	White	Y	Y	Y		
Class P - MGB GT BL & Later										
Gregory Bannon	Tas	17	1972	MGB GT BL	White	Y	Y	Y		
Tony Lupton	Vic	46	1970	MGB GT BL	Blue	Y	Y	Y		
Patricia Mottram	Vic	11	1970	MGB GT BL	Gingers	Y	Y	Y		
David Mottram	Vic	77	1970	MGB GT BL	Gingers		Y	Y		
Hilary Wren	NSW	286	1972	MGB GT BL	Blue	Y				Y
Henk Zwarteveen	Vic	136	1971	MGB GT BL	Blue	Y	Y		Y	
Class Q - MGB GT Rubber Bumper										
Leigh Abertson	SA	252	1976	MGB GT	White	Y				Y
James Brown	Tas	284	1978	MGB GT	Brown	Y				Y
David Hall	Qld	19	1980	MGB GT LE	Pewter					Y
Malcolm Spiden	Qld	70	1976	MGB GT	Blue	Y	Y	Y		
Class R - MGB GT V8 & Costellos										
Brian Cather	SC	101	1974	MGBGT V8	Mirage (Beige/Mauve)	Y	Y	Y		
John Clarke	NSW	20	1975	MGBGT V8	Flamenco Red (Orange)	Y				Y
Tim Edmonds	SA	81	1974	MGBGT V8	Blaze	Y	Y	Y		
Granville Harris	NSW	29	1973	MGBGT V8	Arconite (Purple)	Y	Y		Y	
Alan Nolan	NSW	161	1973	MGBGT V8	Gunmetal Grey	Y	Y	Y		
Warwick Protheroe	NSW	117	1975	MGBGT V8	Blaze	Y	Y	Y		
Graeme Ruby	Gee	22	1973	MGBGT V8	British Racing Green	Y	Y	Y		
Class S - MGC GT & Roadster										
Alan Heritage	NSW	32	1969	MGC GT	Red	Y		Y		Y
Jensine Hough	Vic	266	1969	MGC GT	Tartan Red	Y				Y
Michael Marzi	Vic	280	1969	MGC GT	Mineral Blue	Y				Y
Alan Nolan	NSW	21	1968	MGC GT	Cherry Red	Y	Y	Y		
Mark Wellard	Qld	69	1969	MGC GT	Blue	Y	Y	Y	Y	
Class T - MG Midget										
John Fransen	Qld	67	1967	Midget	Red	Y			Y	Y
Cherie Fransen	Qld	227	1967	Midget	Red				Y	Y

Note: The competitor and entrant entries were correct at the time of publication.

Name	Centre	Entrant Number	Year	Model	Colour	C	M	S	DR	KR
Class T - MG Midget (cont.)										
Andrew Fraser	New	109	1972	Midget	Black	Y	Y	Y		
Michael Fraser	New	37	1972	Midget	Black	Y	Y	Y		
Angela Howie	Tas	203	1968	Midget	Red	Y	Y	Y		
Bev Jones	HR	181	1971	Midget	White	Y	Y	Y		
Stephen Jones	HR	82	1971	Midget	White		Y	Y		
David Norris	Vic	40	1971	Midget	Red	Y	Y	Y		
Ruth Norris	Vic	140	1971	Midget	Red		Y	Y		
Alan Taylor	Vic	38	1970	Midget	Mineral Blue	Y	Y		Y	
Riley Wells	Vic	9	1964	Midget	Red		Y	Y		
Mitchell Wells	Vic	260	1964	Midget	Red		Y			
Class U - MGY Saloon & Tourer										
Robert A'des	Vic	381	1949	YT	Red		Y	Y		
Louise Crowther	Vic	138	1949	YT	Red	Y	Y	Y		
Ewan Ward	Can	211	1950	YT	Black	Y			Y	Y
Class V - MG Magnette ZA to Mk IV										
Peter Baldry	NSW	244	1958	Magnette	Maroon	Y				Y
David Brook	Gee	254	1958	Magnette	Pale Green	Y				Y
Ken Burke	SA	231	1959	Magnette	Red	Y				Y
Doug Hastie	Vic	13	1958	Magnette	Birch Grey	Y			Y	Y
Louise Hastie	Vic	226	1958	Magnette	Birch Grey				Y	Y
Paul Vermont	Vic	220	1958	Magnette	Blue	Y	Y		Y	
Class W - Front Wheel Drive & MG Metro										
Wes Bray	SA	100	1964	MG 1100	Snowberry White	Y	Y			
Max Wasson	NSW	300	1963	MG 1100	White& Red	Y				Y
Bronwyn Zuber	Tas	53	1966	MG 1100	Green/Grey	Y	Y	Y		
Class X - MG Specials (pre MGA)										
Ray Abikhair	Gee	310	1949	TC	Green	Y				Y
Greg Carter	Vic	43	1948	Y Type	Red	Y	Y	Y		
Margaret Crawford	NSW	237	1951	Y Type	Maroon & Cream	Y				Y
Michael Herlihy	Vic	61	1949	TC	Maroon	Y	Y	Y		
Wayne Kirwan	Qld	59	1954	TF	Two Tone Green	Y	Y		Y	
Megan Perrett	Qld	72	1954	TF	Two Tone Green		Y		Y	

Note: The competitor and entrant entries were correct at the time of publication.

Name	Centre	Entrant Number	Year	Model	Colour	C	M	S	DR	KR
Class X - MG Specials (pre MGA) (cont.)										
Syd Reinhardt	NSW	41	1949	TC	Red	Y	Y	Y		
Rob Woodfull	Vic	51	1951	TD	Metallic Clipper Blue	Y			Y	Y
Class Y - MG Specials (post MGT)										
Graeme Adams	Vic	8	1979	Midget	Green	Y	Y	Y		
Craig Ballinger	Gee	68	1976	MGB GT V8	Black	Y	Y	Y		
Peter Beasley	Vic	75	1969	MGB	Red		Y	Y		
Matt Johnson	Qld	64	1964	MGB	Red	Y	Y	Y		
Cameron Lepp	New	31	1964	MGB	Red		Y	Y		
Antoinette Redhead	New	18	1964	MGB	Red	Y	Y	Y		
Graeme Ruby	Gee	122	1972	MGB BL	Gambier Torquise	Y	Y	Y		
Class Z - MG Super Specials May be split as for Specials ie. pre-post.										
Nahum Ayliffe	Vic	33	1970	Midget	White	Y	Y	Y		
Noel Clacher	Vic	76	1970	MGB V8	Jet Red	Y	Y	Y		
Wayne Lodge	Vic	304	1962	Midget	Yellow	Y	Y	Y		
Benjamin Lodge	Vic	305	1962	Midget	Yellow		Y	Y		
Ken McAllister	Gee	277	1968	MGC GT V8	Monza Red	Y				Y
Stephen Riley	Qld	62	1977	MGB	Tiga Mica	Y	Y	Y		
Tony Vollebregt	Vic	48	2001	MG ZR	Grey	Y	Y	Y		
Rodney Wells	Vic	60	1978	Midget	Grey	Y	Y	Y		
Class ZA - MG RV8										
Stuart Boyd	Gee	239	1995	RV8	Red	Y				Y
Jacques Calluud	NSW	205	1995	RV8	Woodcote Green	Y			Y	Y
William Daly	Tas	285	1995	RV8	Nightfire Red	Y				Y
Darren Hodgson	New	90	1995	RV8	Oxford Blue	Y	Y	Y		
Andy Leondiou	NSW	234	1994	RV8	Green	Y				
Jim Vanderkyl	Qld	281	1994	RV8	Red	Y				Y
Class ZB - MG-F										
Mark D'Atri	Vic	213	1999	MGF	Morello Purple	Y	Y			
Allan Fabry	Vic	216	1996	MGF	Charcoal	Y			Y	Y
Ben Gearing	Vic	154	1997	MGF	Red	Y		Y		Y
Suzie Hastie	Vic	208	1999	MGF	Mulberry	Y	Y	Y		
Glenn Kirk	Can	24	2001	MGF	Trophy Blue	Y	Y	Y		
Casey Priestler	Vic	225	1999	MGF	Mulberry		Y	Y		

Note: The competitor and entrant entries were correct at the time of publication.

Name	Centre	Entrant Number	Year	Model	Colour	C	M	S	DR	KR
Class ZB - MG-F (cont.)										
Phil Stafford	Vic	47	1997	MGF	Amaranth	Y		Y		Y
Philip Stapleton	Vic	274	1998	MGF	Red	Y				Y
Class ZC - MG TF										
Bryn Baverstock	New	3	2005	MG TF	Nocturne	Y	Y	Y		
Bruce Fraser	New	39	2003	MG TF	XPower Grey	Y	Y	Y		
Mark Harrington	Tas	65	2004	MG TF	Black				Y	
Max Irvine	Vic	79	2004	MG TF	Goodwood Green	Y				Y
Jon McGovern	Vic	42	2002	MG TF	Silver	Y	Y	Y		
Leon Sims	Vic	91	2004	MG TF	Le Mans Green	Y			Y	Y
Derek Trewarne	Vic	27	2005	MG TF	Red	Y			Y	Y
Jane Vollebregt	Vic	80	2004	MG TF	XPower Grey	Y	Y	Y		
Stefan Ziemer	Vic	218	2003	MG TF	Silver	Y	Y		Y	
Class ZD - All MG sedans after 1st Jan 2000 – 2010.										
Lyall Clarke	New	151	2004	ZS 180	Red	Y	Y	Y		
Lorraine D'Atri	Vic	212	2005	ZS 180	Black	Y			Y	Y
Michael Fraser	New	52	2004	ZT 220S	Black	Y	Y	Y		
Warren Freestone	SC	193	2003	ZT 190	XPower Grey	Y			Y	Y
Fran Hodgson	New	190	2005	ZR	XPower Grey	Y	Y	Y		
Class ZE - MGs post 2010										
Cathy Bartley	Qld	199	2019	ZS	Orange	Y			Y	Y
David Bellenger	Vic	609	2023	ZST	White	Y				
Graham Bradford	Vic	288	2018	MG5	Red	Y				Y
Wes Bray	SA	100	2022	MG3	Grey	Y		Y		
Denise Keele-Bedford	Vic	268	2018	MG3	Red	Y				Y
David McNabb	SA	263	2019	GS	Electric Orange	Y				Y
Jan Rattray	Vic	240	2023	ZST	Diamond Red	Y				
Graeme Ridgway	Vic	207	2024	ZST	Brighton Blue	Y			Y	Y
Class ZZ - Development Category: Non MG Engine Cars										
Dominic David	NSW	195	1967	MGB Mk I	Nurburg White	Y			Y	Y
Panteleimon Matheos	Vic	222	1946	MG Y Type	Black		Y	Y		
Kristen Stafford	Vic	49	1946	MG Y Type	Black	Y	Y	Y		
Chris Wells	Can	2	1969	MGB Mk II	Green				Y	Y

Note: The competitor and entrant entries were correct at the time of publication.

MODERN CLASSIC CARS FOUNDATION



"Enhancing, restoring & maintaining classic cars whilst training the future generation"

Apprenticeships • Training • Commission Builds • Restoration • Upgrades • Services • Parts

Get Involved

MCCF needs the support of specialist vehicle lovers to help us train the next generation and keep the industry alive. Whether you'd like to volunteer your time to share a skill, are in a position to assist with funding or would like to become a business partner, we would love to hear from you.



Our Services

You can help by choosing MCCF for all your classic car needs. Whether it be general service and maintenance work, upgrades and modifications, body work or a full restoration.

Check out some of our services below.

SERVICE WORK

RESTORATION

PAINT & PANEL

PART SALES

02 9773 5943 | sales@modernclassiccars.com.au
 www.modernclassiccars.com.au

The Experts in S.U. Carburettor Restoration Since 1969.

Are your SU carburettors running OK? Now is the perfect time to get them restored to concours condition.

What do we do?
 Disassemble, hydro-bath bodies, replate all metal levers, screws etc. Replace jets, needles, floats, pins & gasket, throttle shaft disc & screws, rebush bodies & assemble.



BOOK YOUR SU CARBS IN FOR RESTORATION AND RECEIVE A FREE BOOK! PLEASE MENTION AD TO REDEEM. OFFER ENDS 30 JUNE 2025

- Complete range of genuine parts
- "In-House" S.U. carburettor restoration service
- S.U. fuel pumps
- Carburettor linkages & ball joints
- Ram tubes / Air cleaners

MIDEL PTY LTD
SINCE 1969

02 9759 5598 www.sumidel.com [su.midel](https://www.instagram.com/su.midel) [SUMidel](https://www.facebook.com/SUMidel)

KIMBER & DISCOVERY RUNS SOCIAL ENTRANTS

Name	Entrant No	KR	DR
Canberra			
Sue Ward	573	Y	
Geelong			
Yvonne Boyd	506	Y	
Cheryl Brook	507	Y	
Lorraine McAllister	544	Y	
Nick McClaren	545	Y	
Laurence Scott	559	Y	
Paula Tsen	567	Y	
Helen Wood	409		Y
Hunter Region			
Maryann Burns	510	Y	
Louise Leddie	538	Y	
New South Wales			
John Bastian	504	Y	
Lynn Callaud	511	Y	
Peter Cook	515	Y	
Matthew Crawford	516	Y	
Irene Harrison	527	Y	
Shirley Heritage	530	Y	
Richard Lamrock	537	Y	
James Lovett	539	Y	
Claudia Lovett	540	Y	
Greg Nolan	551	Y	
Gaye Nolan	552	Y	
Paula Thistleton	562	Y	
Don Young	575	Y	
Queensland			
Jan Burke	508	Y	
Susanne Edwards	517	Y	
David Hall	19		Y (comp)
Lyn Hayward	402	Y	Y
Beth Heraghty	529	Y	
Ann Howlett	403	Y	Y
Vicki Kocsis	536	Y	
Barry Lutwyche	541	Y	
Judy Salt	558	Y	
Karen Thomson	563	Y	
Raye Vanderkyl	571	Y	

Name	Entrant No	KR	DR
South Australia			
Judy Albertson	501	Y	
Michele Bazzica	505	Y	
Heather Burke	509	Y	
Sandra Cardnell	513	Y	
Geoff Glasson	520		Y (comp)
Judy Glasson	521	Y	
Barbara Harrington	526	Y	
Kerry Hugo	404	Y	Y
Kerry Hugo	532	Y	
John Miliado	546	Y	
Bryan Turner	568	Y	
Wendy Turner	569	Y	
Sunshine Coast			
Tracey Freestone	519	Y	
Tasmania			
Cathie Cleaver	514	Y	
Chris Grant	522	Y	
Tony Gurnhill	523	Y	
Cheryl Gurnhill	524	Y	
John Irving	534	Y	
Dawn Irving	535	Y	
Jo Newman	407		Y
Tony Van Tienen	570	Y	
Margret Wood	410		Y
Maxwell Wood	411	Y	Y
TC Owners Club			
Susan Aldous	502	Y	
Victoria			
Mandy Alexander	503	Y	
Graham Bradford	288		Y (comp)
Dallas Bradford	401	Y	Y
Alison Campbell	512	Y	
Pam Fabry	518	Y	
Yani Utami	525	Y	
Hadisuwarno	525	Y	
Maryann Hawthorn	528	Y	

Name	Entrant No	KR	DR
Victoria (cont.)			
Colin Hough	531	Y	
Sharon Hunt	533	Y	
Annette Irvine	405	Y	Y
Max Irvine	79		Y (comp)
Brian Kost	406	Y	Y
Walter Magilton	542	Y	
Zena Marzi	543	Y	
Robert Mitchell	547	Y	
Gary Nauer	548	Y	
Glenda Nelson	549	Y	
Lynley Nimmo	550	Y	
Tom Peitsch	553	Y	
Flossie Peitsch	554	Y	
Pam Prior	555	Y	

Name	Entrant No	KR	DR
Victoria (cont.)			
Vera Ridgway	556	Y	
Louise Robertson	557	Y	
June Rushton	657	Y	
Wayne Rushton	656	Y	
Susan Sims	408	Y	Y
Janet Stafford	561	Y	
Heather Traeger	564	Y	
Chris Traynor	565	Y	
Jenny Trewarne	566	Y	
Douglas Wallace	572	Y	
Lyn Woodfull	574	Y	
Maja Zwarteveen	576	Y	

SOCIAL ENTRANTS

Name	Entrant Number
Geelong	
Julie Ballinger	605
Denise Simons	643
Richard Trigg	647
Helen Trigg	648
Hunter Region	
Claudia Koller	629
Joo Lee	630
Newcastle	
Helen Baverstock	607
Jan Clarke	617
Marta Redhead	641
New South Wales	
Ivanna Arpel	602
Beth Fraser	620
Juliana Protheroe	639
Queensland	
Alan Quinan	640
Roz Riley	642
South Australia	
Chris Bray	612
Michelle Edwards	619

Name	Entrant Number
Sunshine Coast	
Barbara Cather	615
Maria Terry	645
Tasmania	
Susan Fraser	621
Amelia Hanson	624
Duncan Howie	626
Jo Newman	636
Victoria	
Marg Anderson	601
Carmela Ayliffe	603
Lucas Ayliffe	604
Chris Barbour	606
Jean Bellenger	608
Reg Bowran	610
Mary Bowran	611
Alyssa Caldwell	613
Lorraine Carter	614
Laraine Clacher	616
Jenny Duffin	618
Tui Gall	622
Noel Halford	623

Name	Entrant Number
Victoria (cont.)	
Tina Jenkins	628
Imogene Magilton	631
Isobel Magilton	632
Genevieve Magilton	655
Lyn Martin	633
Louise McKenzie	634
Jenny Mouritz	635
Robin Page	637
Mary Pomfret	638
Emma Slawinski	644
Brendan Thomson	646
Peter Varley	650
Sue Vermont	651
Helen Wells	653
Rod Wilson	654
Wagga Wagga	
Leonie Hillyer	625
Robyn Hutton	627
Hannes Vanclay	649
Jacqui Walsh	652

Note: The competitor and entrant entries were correct at the time of publication.

Note: The competitor and entrant entries were correct at the time of publication.

NATIONAL MEETING 2026

IT'S NOT EASTER!

The MG Car Club of SA looks forward to welcoming you at the 2026 MG National Meeting.

And next year's event will NOT be held over Easter – it will be from Monday 27th April to Friday 1st May, inclusive.

There are many reasons for this – one of them being that accommodation is easier to find and should cost a little less. So, no excuses – come along and have a great time.



Clearly, the Adelaide Hills Convention Centre will be the hub of all activities and it offers a large range of accommodation options including:

- Lakeview units
- Lakeview houses
- Lakeview cabins
- Studio cottages
- Studio cabins
- Powered drive-through sites
- Powered sites.

Another change is that we're not centring the event around Glenelg in 2026. Instead, we're moving to the beautiful Adelaide Hills and specifically Hahndorf, one of SA's premier tourist attractions. Our base will be the Adelaide Hills Convention Centre (AHCC) run by Discovery Events. This will be the epicentre for many National Meeting social events, and this is how the program is shaping up:

- Monday 27th April – Registration; Noggin'n'Natter/Rocker Cover Race all at AHCC
- Tuesday 28th April – Concours at Mount Barker; Dress-up Dinner at AHCC
- Wednesday 29th April – Motorkhana at The Bend; Kimber Run leaving from AHCC and finishing at The Tavern on Hindmarsh Island
- Thursday 30th April – Sprint at The Bend; Discovery Run leaving from nearby Mount Barker and finishing at Murray Bridge; Formal Dinner at AHCC
- Friday 1st May – Farewell Breakfast and Delegate's Meeting at AHCC.

The Bend Motorsport Park at Tailm Bend is less than an hour away on National Highway M1.



There's also ample car parking. To book accommodation there, simply phone them on (08) 8388 7921 and they will be happy to take your details.

Hahndorf offers many other accommodation options and attractions and you can find details at the usual places such as Booking.com, Tripadvisor, Wotif etc.

If you're not familiar with Hahndorf and its surrounds, have a look at <https://southaustralia.com/destinations/adelaide-hills/places/hahndorf>

We will have photos and information available at the Albury/Wodonga registration area this Easter.

As you can see, planning is already well advanced and we'll keep you informed as more details are finalised. Book your accommodation, watch out for registration details on the 2026 MG National Meeting website 2026mgnationalmeeting.com.au and please direct any queries to Tim Edmonds at Chairman2026natmeet@outlook.com

The MG Car Club of SA looks forward to giving you a very warm welcome in 2026.

MGCC

Helloworld Travel Wheelers Hill & Waverley Gardens is locally owned and operated with well-travelled, professional and friendly travel experts. See the team for informed choices, niche services with competitive pricing.

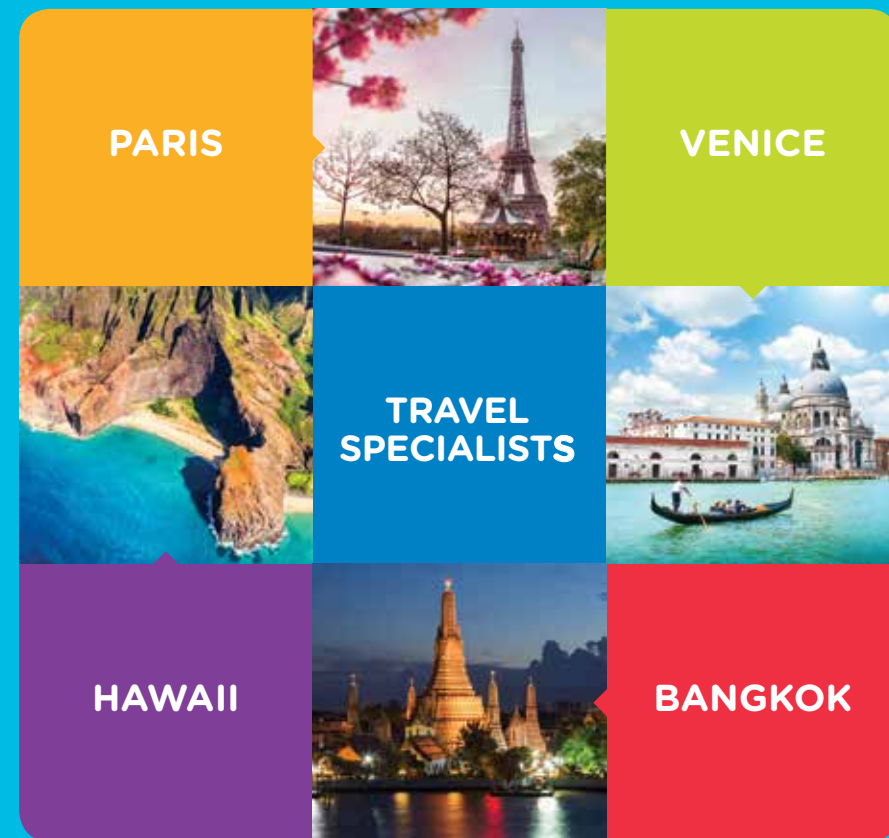

HELLOWORLD TRAVEL WHEELERS HILL & WAVERLEY GARDENS

P: (03) 9562 0282

E: wheelershill@helloworld.com.au
E: waverleygardens@helloworld.com.au

helloworld
TRAVEL
THE TRAVEL PROFESSIONALS



**THANK YOU FROM VICTORIA
AND SEE YOU NEXT YEAR
IN SOUTH AUSTRALIA**